

Weight Indicator



FEATURES

- Housed in a box of rigid stainless steel
- Three different levels can be monitored
- Pre-set level values can be shown
- Computer communication via interfaces RS-232 or RS-485

DESCRIPTION

WIN 3, is housed in a rigid IP-65 box of stainless steel and contains only circuits which are required for presentation of weight and monitoring of levels. Gross weight, Net weight and Tare can be requested on the front panel. The remaining keys are used for simple setting-up and calibration of the instrument.

Three different levels can be monitored. Each level can be programmed to monitor gross, net or displayed weight. Pre-set level values can be shown at any time.

WIN 3 has an analogue current or voltage output for the connection of an analogue recording device or slave instrument. Computer communication is carried out via interfaces RS-232 or RS-485.

The integrity of the weight value is guaranteed by automatic functioning inspection of the electronics, and watchdog monitoring.

APPLICATIONS

Process Weighing

POSSIBILITIES

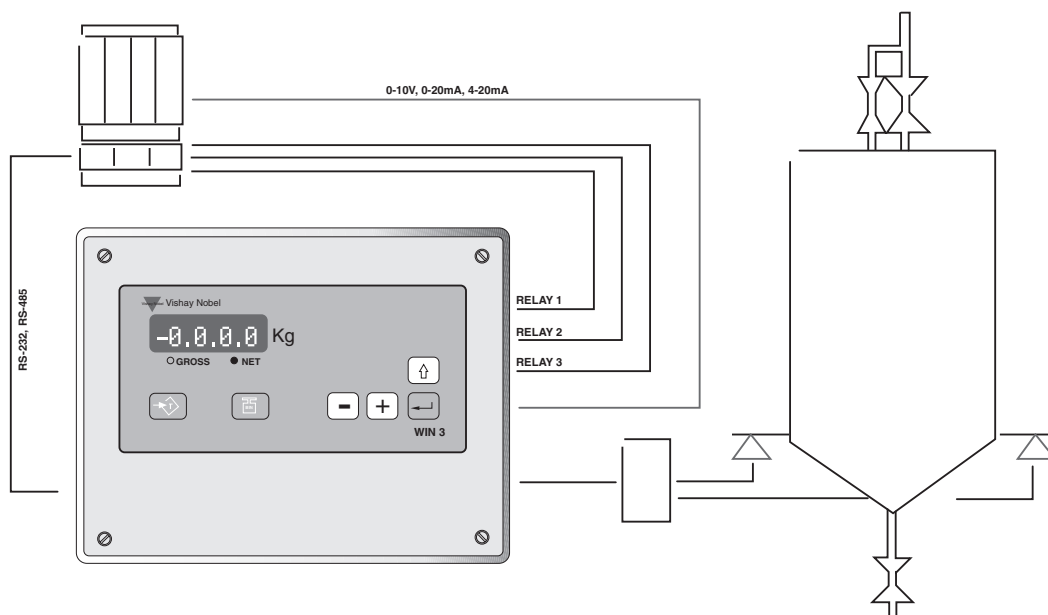

SPECIFICATIONS

Display \pm sign and 4 digits (7 segment LED'S)
Height 15mm. Selectable resolution.
Recommended up to 3000 divisions for mV/V input signal.

Level relays

Number of relays 3 independent.
Relay type 1 change over.
Contact data Max. 2A, 30V AC/DC.

Transducer input

Excitation 10V \pm 5 %, max. 150mA. Symmetrical to earth.

Sense-input 2-10V. Low sense will increase noise level up to 4 μ Vp-p.

Update time <0.4s.

Input for full scale 4mV/V. (40mV at 10V sense input)

Temperature effects of the signal to digital conversion
on zero <0.1 μ V/ $^{\circ}$ C
on gain <15ppm/ $^{\circ}$ C

Analogue output

Voltage output 0-10VDC, max 10mA, optoisolated or

Current output 0-20mA, 4-20mA, optoisolated, max. 500 ohm resistive load.

Resolution More than 5000 steps

Temperature effects of the digital to output conversion
on zero <0.006%/ $^{\circ}$ C
on gain <50ppm/ $^{\circ}$ C

Interface RS-232/RS-485

Power supply 94-132VAC/200mA,
187-264VAC/100mA, 48-62Hz

Temperature range 0- +50 $^{\circ}$ C

Connections Connector blocks with screw terminals.

Protection IP 65

DIMENSIONS

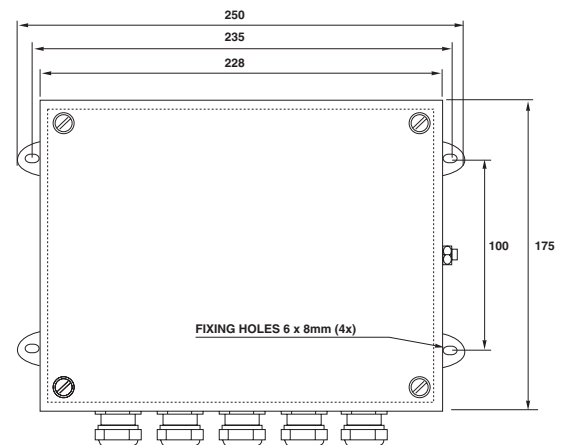
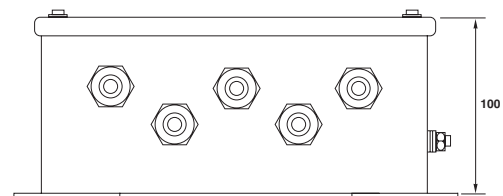

Disclaimer

All product specifications and data are subject to change without notice.

Vishay Precision Group, Inc., its affiliates, agents, and employees, and all persons acting on its or their behalf (collectively, "Vishay Precision Group"), disclaim any and all liability for any errors, inaccuracies or incompleteness contained herein or in any other disclosure relating to any product.

Vishay Precision Group disclaims any and all liability arising out of the use or application of any product described herein or of any information provided herein to the maximum extent permitted by law. The product specifications do not expand or otherwise modify Vishay Precision Group's terms and conditions of purchase, including but not limited to the warranty expressed therein, which apply to these products.

No license, express or implied, by estoppel or otherwise, to any intellectual property rights is granted by this document or by any conduct of Vishay Precision Group.

The products shown herein are not designed for use in medical, life-saving, or life-sustaining applications unless otherwise expressly indicated. Customers using or selling Vishay Precision Group products not expressly indicated for use in such applications do so entirely at their own risk and agree to fully indemnify Vishay Precision Group for any damages arising or resulting from such use or sale. Please contact authorized Vishay Precision Group personnel to obtain written terms and conditions regarding products designed for such applications.

Product names and markings noted herein may be trademarks of their respective owners.